

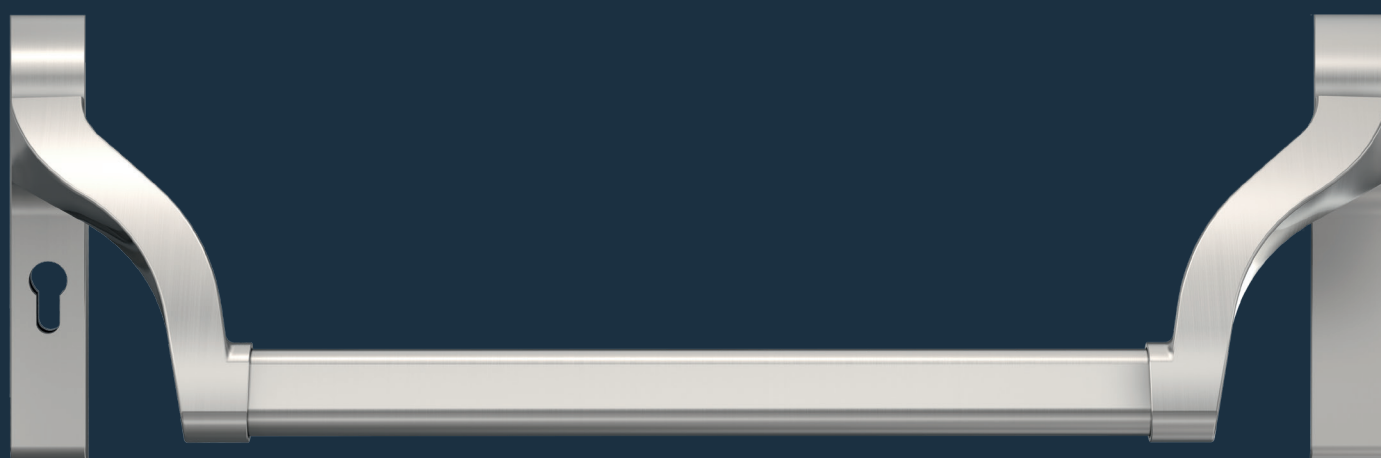



ECO EPN 900 IV

Product information

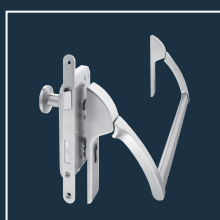
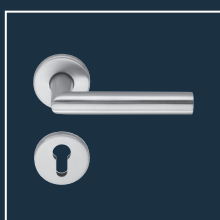

■ SYSTEM TECHNOLOGY FOR THE DOOR



Product characteristics		
Mode of operation	Touchbar Pushbar	- ■
Finish	Stainless steel	■
	Aluminium F1 coated	■
	Colour coated	■
Grip tube	900*	■
	1.150*	■
	1.500*	□
Lock type	PZ-72	■
	PZ-92	■
	RZ-74	■
	RZ-94	■
	UG (blind)	■
DIN left / right usable		■
Suitable for the use on fire- and smoke control doors	F	■
Tested acc. to DIN / EN	EN 1125 	■

■ Yes - No □ Option

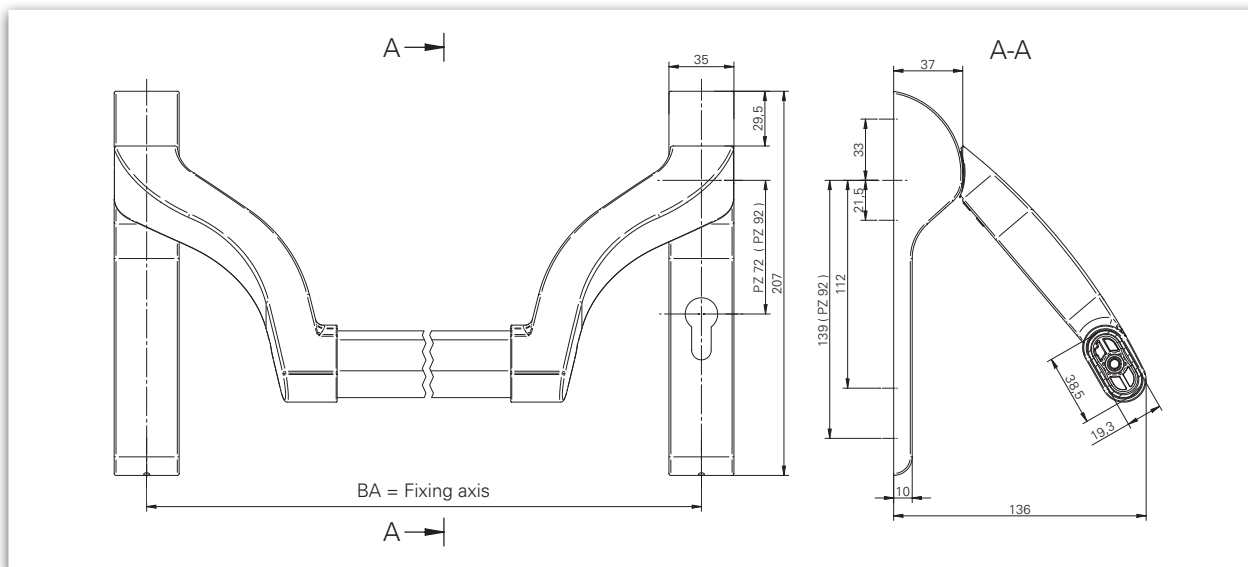

Dimensioning: EPN 900 IV (subject to change)

Description

EPN 900 IV / Pushbar

The arms are highly cranked and enable the use of electronic key cylinders.

- Tested acc. to **EN 1125, EN 1634, EN 1191**
- Can be used according to **EN 1125** only with tested and approved lock
- Suitable for the use on fire- and smoke control doors according testing
- DIN left / right usable
- Arms highly cranked, suitable in particular for electronic key cylinders and short PZ distances
- Large, stable grip tube (vandalism)
- High-strength screwing of arm and tube

- Finish:
 - Stainless steel satin brushed
 - Silver Aluminium F1 coated**
 - Black / red coated** (on basis EPN 900 IV Aluminium)
- Gear unit: Steel zinc-plated

*Tube has to be ordered seperately
** Please see our notes





EPN 900 IV Stainless steel *	Rotation angle	Article number
PZ-72	30°	1069a1304600080
	40°	1069a1404600080
	45°	1069a1454600080
PZ-92	30°	1069a2304600080
	40°	1069a2404600080
	45°	1069a2454600080
RZ-74	30°	1069a5304600080
	40°	1069a5404600080
	45°	1069a5454600080
RZ-94	30°	1069a6304600080
	40°	1069a6404600080
	45°	1069a6454600080
Ungelocht UG	30°	1069a4304600080
	40°	1069a4404600080
	45°	1069a4454600080

Grip tube ER	Fixing axis (BA) max.	Article number
900 mm	1.067 mm	109506604600070
1.150 mm	1.317 mm	109506614600070
1.500 mm	1.669 mm	109506644600070

EPN 900 IV
Stainless steel

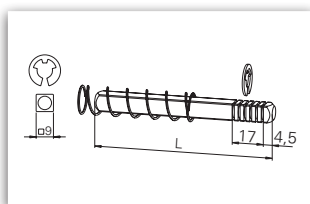

Length	Article number
55 mm	119007914301030
75 mm	119007924301030
95 mm	119007934301030

*Grip tube has to be ordered separately
** Please see our notes



EPN 900 IV - Pushbar



AI

F

EN 1125 

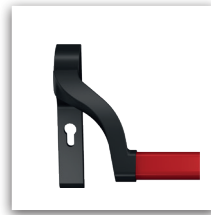

Ku

F

EN 1125 

EPN 900 IV AI *	Rotation angle	Article number
PZ-72	30°	1069a1303000080
	40°	1069a1403000080
	45°	1069a1453000080
PZ-92	30°	1069a2303000080
	40°	1069a2403000080
	45°	1069a2453000080
RZ-74	30°	1069a5303000080
	40°	1069a5403000080
	45°	1069a5453000080
RZ-94	30°	1069a6303000080
	40°	1069a6403000080
	45°	1069a6453000080
UG (blind)	30°	1069a4303000080
	40°	1069a4403000080
	45°	1069a4453000080

EPN 900 IV * colourized	Rotation angle	Article number
PZ-72	30°	1069a1300200080
	40°	1069a1400200080
	45°	1069a1450200080
PZ-92	30°	1069a2300200080
	40°	1069a2400200080
	45°	1069a2450200080
RZ-74	30°	1069a5300200080
	40°	1069a5400200080
	45°	1069a5450200080
RZ-94	30°	1069a6300200080
	40°	1069a6400200080
	45°	1069a6450200080
UG (blind)	30°	1069a4300200080
	40°	1069a4400200080
	45°	1069a4450200080

Grip tube AI	Fixing axis (BA) max.	Article number
900 mm	1.067 mm	109507003000070
1.150 mm	1.317 mm	109507013000070
1.500 mm	1.669 mm	109507023000070

Grip tube AI red coated	Fixing axis (BA) max.	Article number
900 mm	1.067 mm	109507000100070
1.150 mm	1.317 mm	109507010100070
1.500 mm	1.669 mm	109507020100070

EPN 900 IV
Aluminium F1 coated **

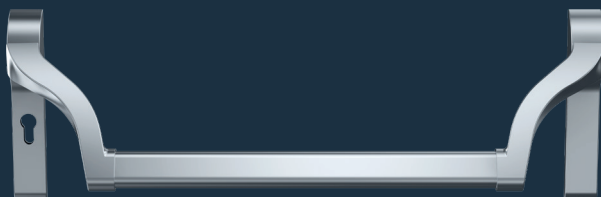

EPN 900 IV
Black / red coated **

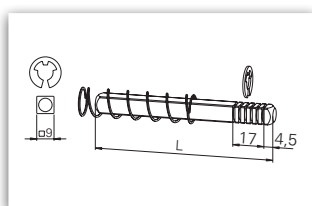

Length	Article number
55 mm	119007914301030
75 mm	119007924301030
95 mm	119007934301030

*Grip tube has to be ordered separately
** Please see our notes



ECO Schulte GmbH & Co. KG
Iserlohner Landstraße 89
D - 58706 Menden

Telefon: +49 2373/9276-0
Fax: +49 2373/9276-40

info@eco-schulte.de
www.eco-schulte.de

© ECO Schulte GmbH & Co. KG - Änderungen vorbehalten
© ECO Schulte GmbH & Co. KG - Subject to change