

ECO GBS 91

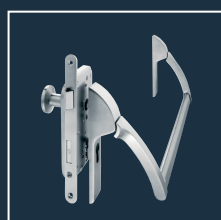

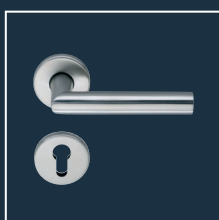

Product information

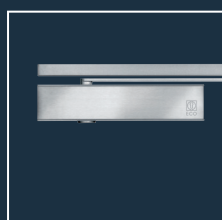

■ SYSTEM TECHNOLOGY FOR THE DOOR



GBS 91

Product characteristics		
Lock type	PZ-72 (handle / knob execution)	■
	RZ-74 (handle / knob execution)	□
Backset	55	■
	65	■
Face plate	Stainless steel	■
Face plate width	20 round (rebate)	■
	24 round (flush)	■
Hub	9 mm	■
Suitable for the use on fire- and smoke control doors	F	■
Tested and approved acc. to DIN / EN	EN 179  EN 1125 	
	EN 12 209 DIN 18 250	
■ Yes - No □ On request		
 Wooden door  Steel door		

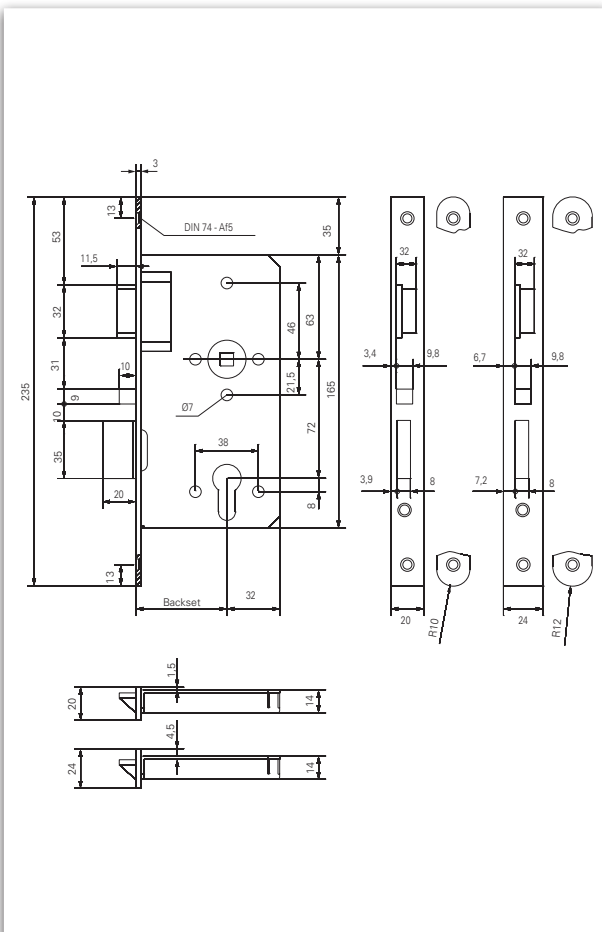

Dimensioning: GBS 91

Description

- Automatic self-engaging mortise lock with panic function
- Stainless steel latches and dead bolt
- Closed lock case with 3-fold fastening with protection bushes
- Suitable for fire- and smoke control doors
- Tested and approved acc. to **EN 179, EN 1125, EN 12 209, EN 18 250**
- Automatic locking of the door by pressing the auxiliary latch when the door is closed
- Optional extras possible
 - Dead bolt monitoring
 - Lever locking

Individual stamping possible on request and at an extra charge.



ECO

GBS 91 ■ Automatic self-engaging panic mortise lock (AVP)

Face plate finish	Backset in mm	Face plate form	Face plate 20 x 235 mm / PZ-72 (handle / knob execution)		Face plate 24 x 235 mm / PZ-72 (handle / knob execution)	
			DIN left	DIN right	DIN left	DIN right
Stainless steel	55	round	2091aha02h34308	2091aha02h34408	2091aha02m34308	2091aha02m34408
	65	round	2091aja02h34302	2091aja02h34402	2091aja02m34100	2091aja02m34200

ECO Schulte GmbH & Co. KG
Iserlohner Landstraße 89
D - 58706 Menden

Telefon: +49 2373/9276-0
Fax: +49 2373/9276-40

info@eco-schulte.de
www.eco-schulte.de

© ECO Schulte GmbH & Co. KG - Änderungen vorbehalten
© ECO Schulte GmbH & Co. KG - Subject to change