



ECO GBS 92





Product information

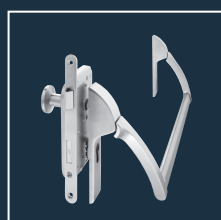
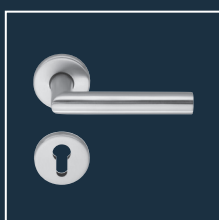
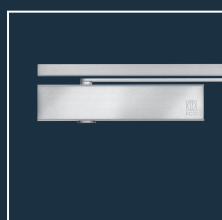

■ SYSTEM TECHNOLOGY FOR THE DOOR





Product characteristics		
Lock type	PZ-72	■
	RZ-74	□
Backset	55	□
	65	■
	80	■
	100	■
Panic function	B B- inwards	■
	C C- inwards	■
	D D- inwards	■
	E	■
Face plate	Stainless steel	■
Face plate width	20 round (rebate)	■
	24 round (flush)	■
Hub	9 mm	■
Suitable for the use on fire- and smoke control doors	F	■
Tested and approved acc. to DIN / EN	EN 179 	EN 1125 
	DIN 18 250	EN 12 209
<p>■ Yes - No □ On request</p> <p> Wooden door  Steel door</p>		

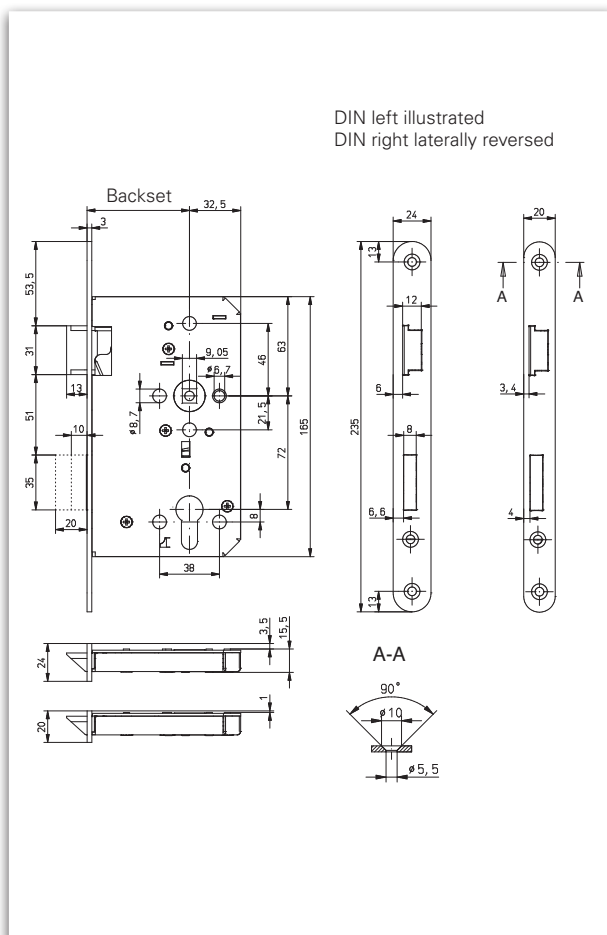

Dimensioning: GBS 92 / Panic function D

Description

- Panic mortise lock
- Tested and approved acc. to **EN 179, EN 1125, DIN 18 250** and **EN 12 209**
- For single lead wooden- and steel fire and smoke control doors
- Face plate square on request

Individual stamping possible on request and at an extra charge.

Panic function E

Face plate finish	Backset in mm	Face plate form	Face plate 20 x 235 mm / PZ-72 (handle / knob execution)		Face plate 24 x 235 mm / PZ-72 (handle / knob execution)	
			DIN left	DIN right	DIN left	DIN right
Stainless steel	65	round	2092_ja02h34100	2092_ja02h34200	2092_ja02m34100	2092_ja02m34200
	80	round	2092_ma02h34100	2092_ma02h34200	2092_ma02m34100	2092_ma02m34200
	100	round	2092_qa02h34100	2092_qa02h34200	2092_qa02m34100	2092_qa02m34200

Panic function D

Face plate finish	Backset in mm	Face plate form	Face plate 20 x 235 mm / PZ-72		Face plate 24 x 235 mm / PZ-72	
			DIN left	DIN right	DIN left	DIN right
Stainless steel	65	round	2092_ja02h35100	2092_ja02h35200	2092_ja02m35100	2092_ja02m35200
	80	round	2092_ma02h35100	2092_ma02h35200	2092_ma02m35100	2092_ma02m35200
	100	round	2092_qa02h35100	2092_qa02h35200	2092_qa02m35100	2092_qa02m35200

Panic function B

Face plate finish	Backset in mm	Face plate form	Face plate 20 x 235 mm / PZ-72		Face plate 24 x 235 mm / PZ-72	
			DIN left	DIN right	DIN left	DIN right
Stainless steel	65	round	2092_ja02h33100	2092_ja02h33200	2092_ja02m33100	2092_ja02m33200
	80	round	2092_ma02h33100	2092_ma02h33200	2092_ma02m33100	2092_ma02m33200
	100	round	2092_qa02h33100	2092_qa02h33200	2092_qa02m33100	2092_qa02m33200

Panic function C

Face plate finish	Backset in mm	Face plate form	Face plate 20 x 235 mm / PZ-72		Face plate 24 x 235 mm / PZ-72	
			DIN left	DIN right	DIN left	DIN right
Stainless steel	65	round	2092_ja02h32100	2092_ja02h32200	2092_ja02m32100	2092_ja02m32200
	80	round	2092_ma02h32100	2092_ma02h32200	2092_ma02m32100	2092_ma02m32200
	100	round	2092_qa02h32100	2092_qa02h32200	2092_qa02m32100	2092_qa02m32200

Panic function D inwards

Face plate finish	Backset in mm	Face plate form	Face plate 20 x 235 mm / PZ-72		Face plate 24 x 235 mm / PZ-72	
			DIN left	DIN right	DIN left	DIN right
Stainless steel	65	round	2092_ja02h39100	2092_ja02h39200	2092_ja02m39100	2092_ja02m39200
	80	round	2092_ma02h39100	2092_ma02h39200	2092_ma02m39100	2092_ma02m39200
	100	round	2092_qa02h39100	2092_qa02h39200	2092_qa02m39100	2092_qa02m39200

Panic function B inwards

Face plate finish	Backset in mm	Face plate form	Face plate 20 x 235 mm / PZ-72		Face plate 24 x 235 mm / PZ-72	
			DIN left	DIN right	DIN left	DIN right
Stainless steel	65	round	2092_ja02h37100	2092_ja02h37200	2092_ja02m37100	2092_ja02m37200
	80	round	2092_ma02h37100	2092_ma02h37200	2092_ma02m37100	2092_ma02m37200
	100	round	2092_qa02h37100	2092_qa02h37200	2092_qa02m37100	2092_qa02m37200

Panic function C inwards

Face plate finish	Backset in mm	Face plate form	Face plate 20 x 235 mm / PZ-72		Face plate 24 x 235 mm / PZ-72	
			DIN left	DIN right	DIN left	DIN right
Stainless steel	65	round	2092_ja02h38100	2092_ja02h38200	2092_ja02m38100	2092_ja02m38200
	80	round	2092_ma02h38100	2092_ma02h38200	2092_ma02m38100	2092_ma02m38200
	100	round	2092_qa02h38100	2092_qa02h38200	2092_qa02m38100	2092_qa02m38200

ECO Schulte GmbH & Co. KG
Iserlohner Landstraße 89
D - 58706 Menden

Telefon: +49 2373/9276-0
Fax: +49 2373/9276-40

info@eco-schulte.de
www.eco-schulte.de

© ECO Schulte GmbH & Co. KG - Änderungen vorbehalten
© ECO Schulte GmbH & Co. KG - Subject to change